

# AREA LIGHT INSTALLATION INSTRUCTIONS

## IMPORTANT

### PLEASE READ ALL INSTRUCTIONS BEFORE ATTEMPTING INSTALLATION

- To prevent personal injury or product damage only licensed electricians should install.
- To avoid electric shock or component damage disconnect power before attempting installation or servicing
- This product must be installed in accordance with the national electric code (NEC) and all applicable federal, state and local electric codes and safety standards
- Disconnect product and allow cooling prior to servicing.
- Any alteration or modification of this product is expressly forbidden as it may cause serious personal injury, death, property damage or product malfunction
- To prevent product malfunction and electrical shock this product must be properly grounded
- This luminaire is designed to operate in ambient temperatures ranging from -40°C to 40°C and to be horizontally mounted with the LEDs facing down.
- This product must be installed in accordance with the applicable installation code by a Person familiar with the construction and operation of the product and the hazards involved
- MIN 75°C SUPPLY CONDUCTORS
- CONSULT A QUALIFIED ELECTRICIAN TO ENSURE CORRECT BRANCH CIRCUIT CONDUCTOR
- CAUTION -RISK OF FIRE.
- Adjustable Arm/ Slip Fitter/ Trunnion Mounted with PHOTOCELL function tilt angle should not exceed 15 degrees
- This product is not available for several special environments, such as places with corrosive gas liquids or high pressure water vapor.

## SLIPFITTER MOUNTING

1. Remove two screws on side of round cover plate, and install the slip fitter onto the fixture.
2. Install two screws on side of round cover plate ,connect the wires correctly ,place the slip fitter over the pole and secure the fixture with the set screws on the side of the slip fitter.
3. Remove the G1/2 screw plug , loosen the locking bolt and swivel fixture to desired angle.
4. Tighten the Locking Bolt and Install the G1/2 screw plug.

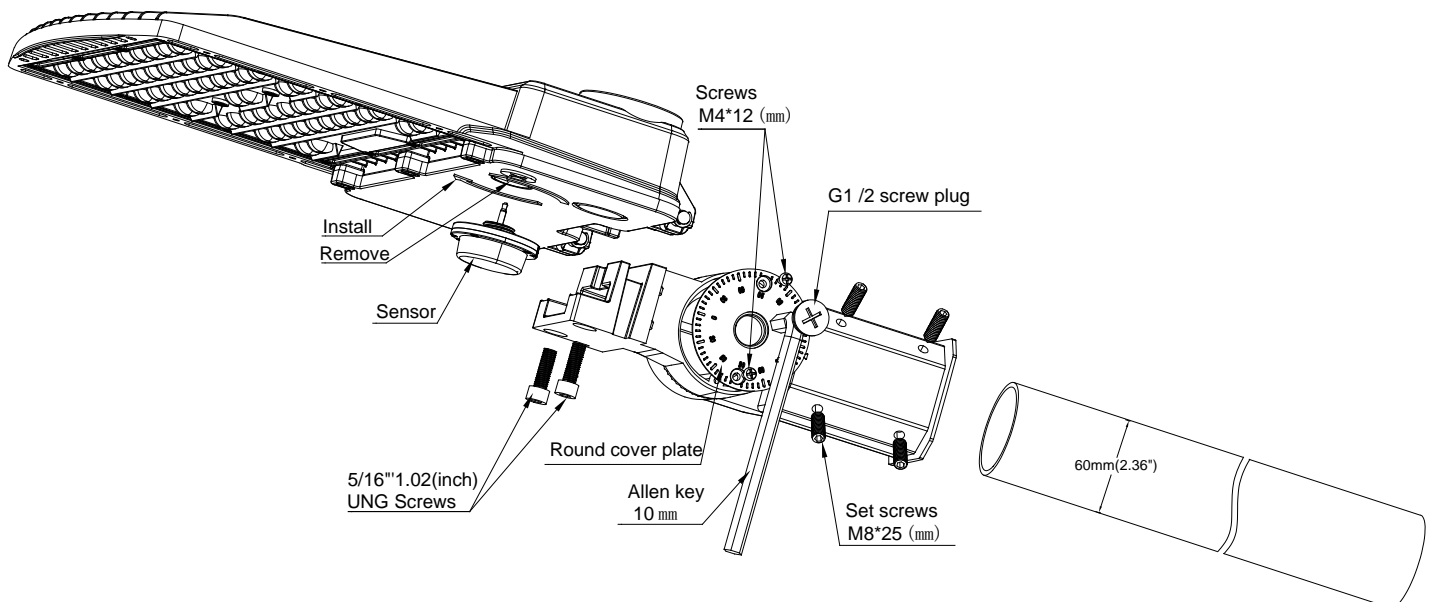

# AREA LIGHT INSTALLATION INSTRUCTIONS

## ADJUSTABLE ARM MOUNTING

### Square /Round Pole Installation:

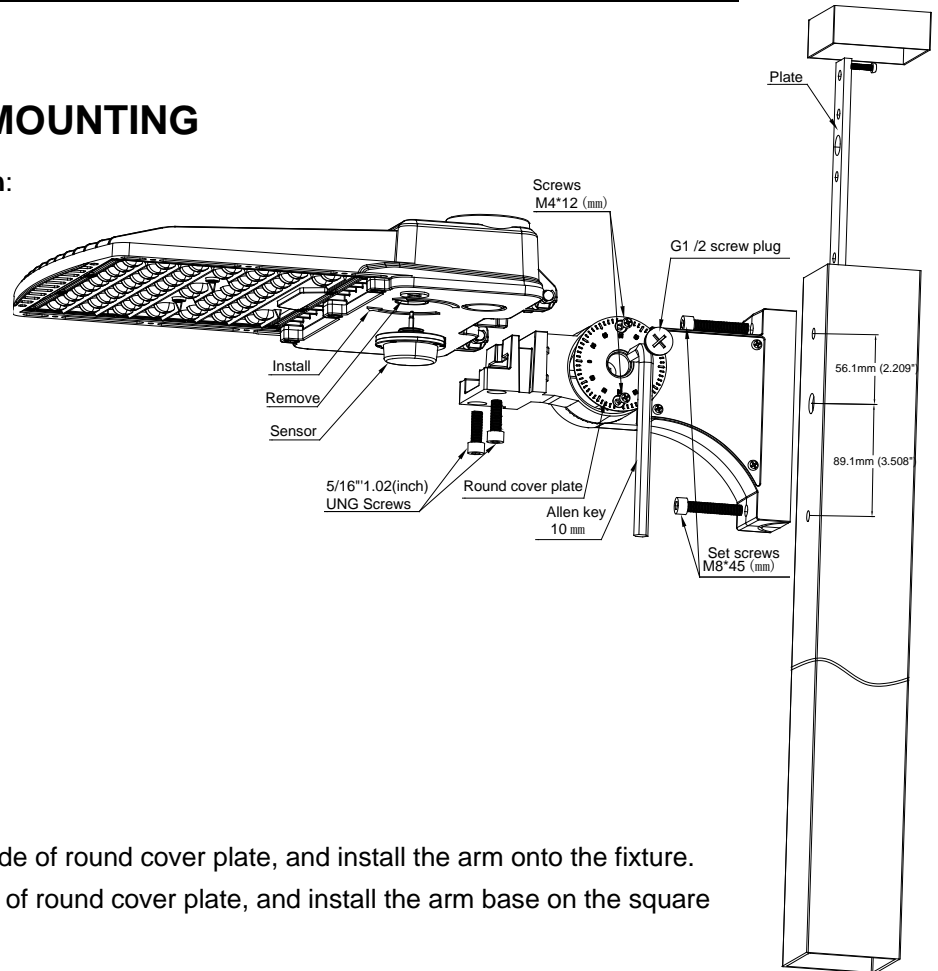

1. Remove two screws on side of round cover plate, and install the arm onto the fixture.
2. Install two screws on side of round cover plate, and install the arm base on the square pole or round pole.
3. Connect the wires correctly, install the pole waterproof cover ,
4. Remove the G1/2 screw plug, loosen the locking bolt and swivel fixture to desired angle.
5. Tighten the Locking Bolt and Install the G1/2 screw plug.

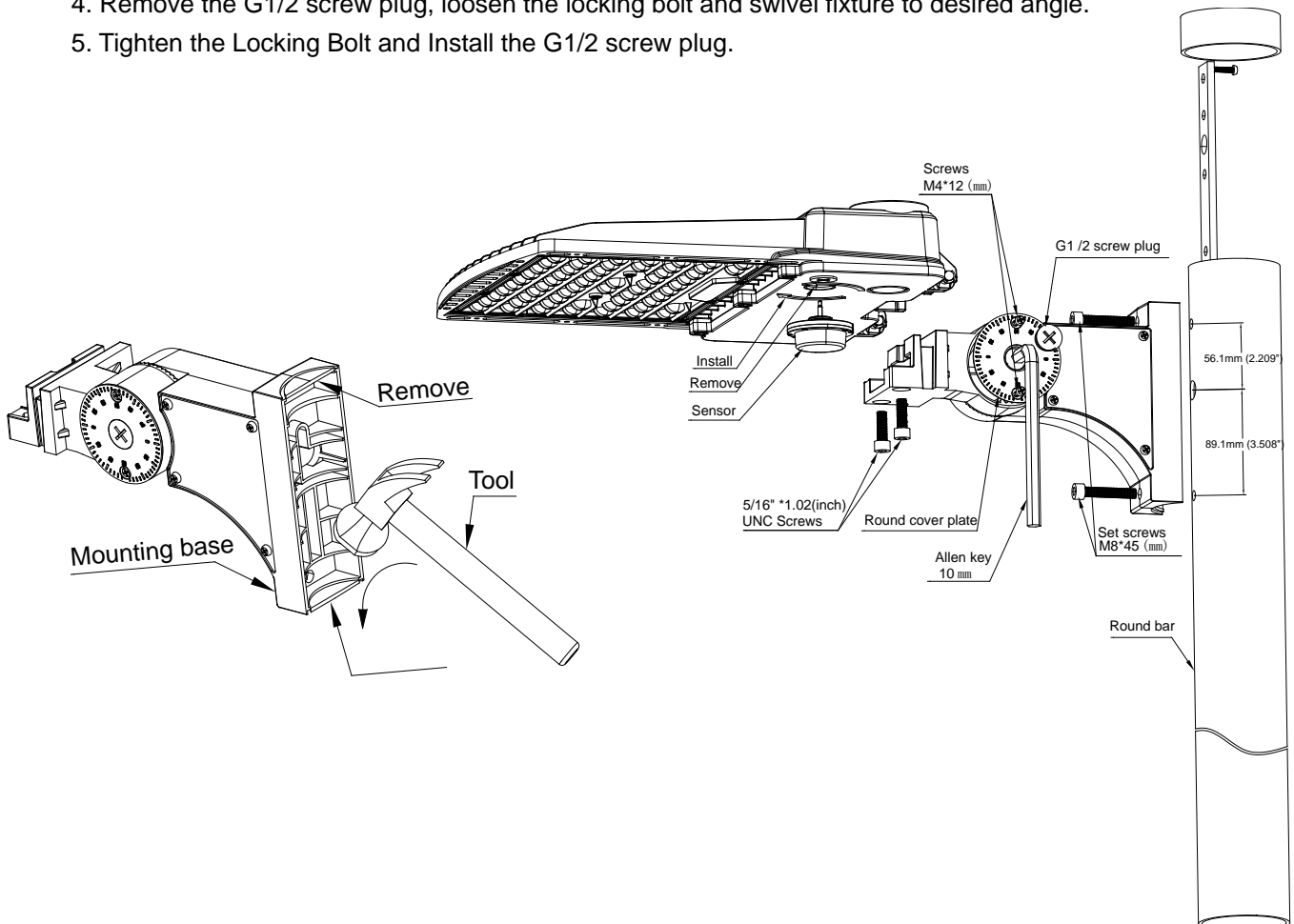

# AREA LIGHT INSTALLATION INSTRUCTIONS

## TRUNNION MOUNTING

1. Mount fixture onto surface using the hole pattern provided on the trunnion bracket.
2. Loosen center bolts and set screw.
3. Rotate fixture to desired aiming position and tighten center bolts.
4. Make wiring connection as per wire diagram below.
5. After fixing the bracket at certain angle, the four Hexagon socket screws should be locked by manual wrench

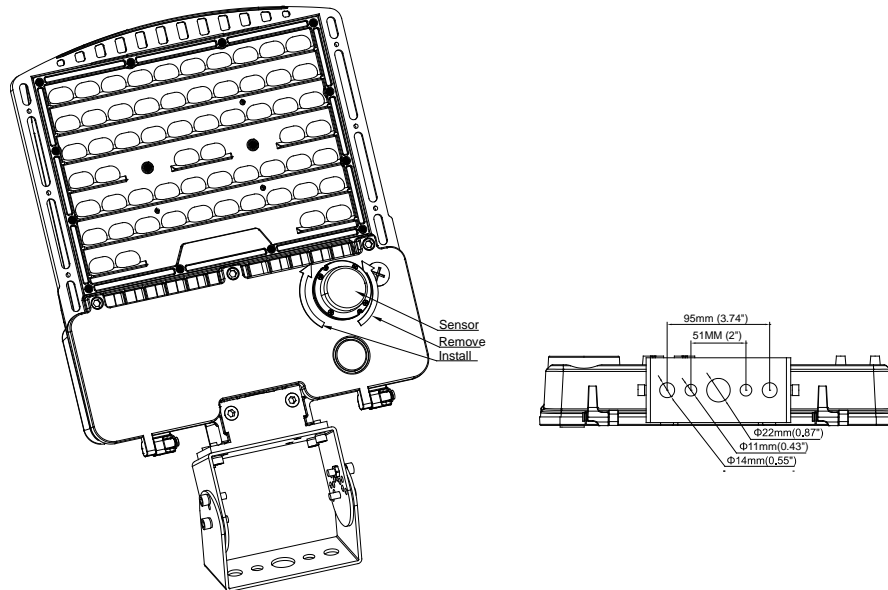

## Power and CCT selectable version

1. Remove the G1/2screw plug on the bottom of the fixture.
2. Select Power(White) and CCT(Black) by sliding the respective switch to the desired value according to the figure.
3. Replace the G1/2screw plug and tighten with a flat head screwdriver.

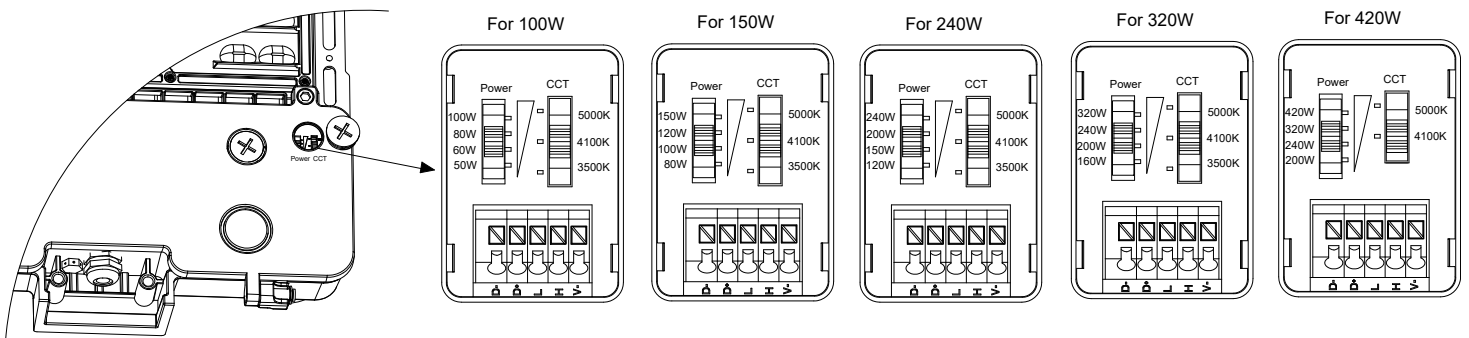

# AREA LIGHT INSTALLATION INSTRUCTIONS

## WIRING

**WARNING: Before Wring, Make certain the input voltage is correct!**

1. Connect the black fixture lead to the LINE supply lead.
2. Connect the white fixture lead to the neutral supplylead.
3. Connect the green wire from fixture to supply ground

