

PIR Bluetooth Sensor Daylight Harvesting

SKU: AA-SENPIRBT-BRI819PBDBLE >100W



Description

The Dimming PIR Occupancy sensor is used for indoor lighting fixtures and provides multi-level control based on motion. Designed for use in commercial and industrial installations (indoor and outdoor rated versions are available).



Features

Sharkward high bay/low bay PIR occupancy sensor is designed for use in commercial and industrial installations (indoor and outdoor rated versions are available).

High bay/low bay PIR occupancy sensor is a line voltage sensor, so no additional power pack is required. the standard version accepts 120-277VAC input, but we also have versions which accept 120-347VAC input.

This product series uses passive infrared (PIR) technology to detect motion. It is best suited for detecting tangential motion in areas with stable ventilation and clear line of sight.

Factory installed high bay lens supports mounting heights up to 40ft. Optional low bay lens is available for mounting heights 25ft or less. Both lenses provide 360 degree coverage. Special covers are available to adapt this detection pattern for use in aisles. Users can adjust sensitivity, time delay, and other settings via a dip switch.

Applications

- Shopping Malls
- Warehouses & Distribution Centers
- Parking Garages
- Assembly Areas

Ordering Information



SKU	Model	Description	Power Supply	Maximum Load	PIR Len L1	PIR Len L1	Sheath Wire	IP Rating	Temperature
AA-SENPIRBT-BRI819PBDBLE	BRI819P-B-D-BLE	PIR Occupancy Sensor	120-277VAC,	Resistive/Tungsten: 600W@120V Electronic Ballast: 800W@120V/1200W@277V	30ft @ 25ft height/360°	30ft @ 40ft height/360°	X	IP65	-40°F~167°F -40°C~75°C

Dimensions

Indoor(IP20) Sensor Enclosure

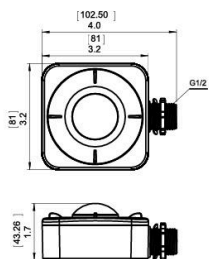

Outdoor(IP65) Sensor Enclosure

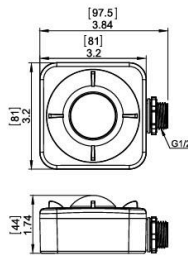

EM1 Enclosure

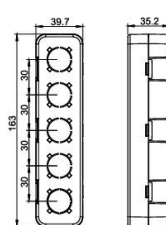

EM1B Enclosure

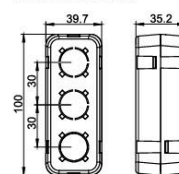

Mounted To LED Linear High Bay

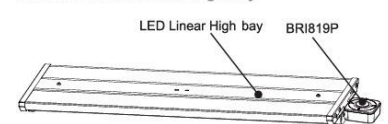

Detection Coverage

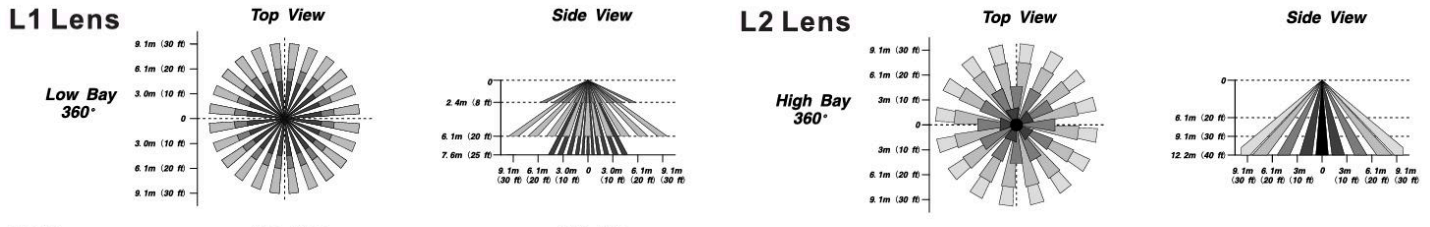

Wiring Diagrams

Wiring with non-dimming ballast or LED driver.

ON/OFF Sensor

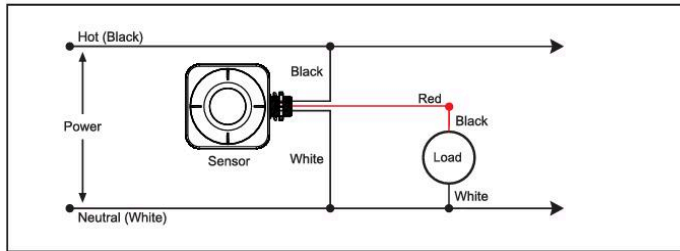

Wiring with dimming ballast or LED driver.

Dimming Sensor

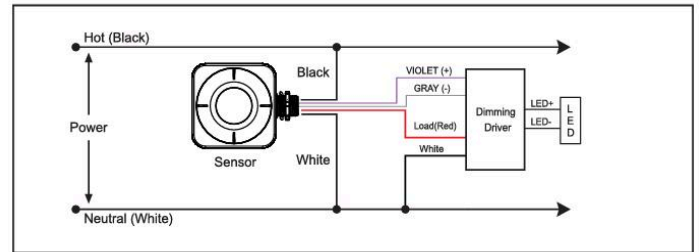

Sensor Functions

ON/OFF Function

The sensor is a motion-sensitive switch that controls lighting. Lights go on when people are around and off when no one is around. The sensor has a built-in light sense and only works if the ambient brightness is lower than the light sense setting.



With sufficient natural light, the light does not switch on when presence is detected.

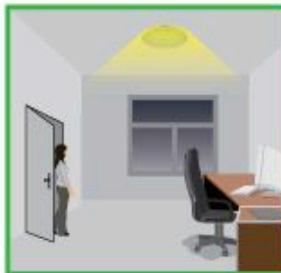

With insufficient natural light, the sensor switches on the light automatically when presence is detected.



Light switches off automatically after the stand-by time elapses.

Sensor Functions

Dimming Function

This function inside the motion sensor to achieve tri-level control, for some areas which require a light change notice before switch-off. The sensor offers 3 levels of light: 100%-->dimmed light (natural light is insufficient) -->off; and 2 periods of selectable waiting time: motion hold-time and stand-by period; Selectable daylight threshold and freedom of detection area.



With sufficient natural light, the light does not switch on when presence is detected.



With insufficient natural light, the sensor switches on the light automatically when presence is detected.



After hold-time, the light dims to stand-by level if the surrounding natural light is below the daylight threshold.



Light switches off automatically after the stand-by period elapses.

Daylight Harvesting Function

Open the daylight harvesting function only by choosing button when remote control is in setting condition. Memory and maintain current ambient brightness.

Settings on this demonstration:

Brightness: 100%
Sensitivity: 100%
Hold Time: 30Min
Daylight Sensor:
Stand-By Dim: 30%
Stand-By Time: 1Min

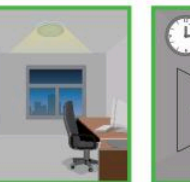

When the natural light is sufficient or dark, movement is detected and the light will turn on 100% brightness.

The light turns on at full or dims to maintain the lux level. The light output regulates according to the level of natural light available.

The light dims to stand-by period after hold-time and stays on selected minimum dimming level.

The light switches off completely after the stand-by period.